

DS-2CE5512P(N) 500TVL DIS Dome Camera



Key features

- 1/4" DIS
- 500 TVL resolution
- Day / night auto switch
- 3-axis adjustment
- Compact design
- Wide operating temperature range

Dimensions

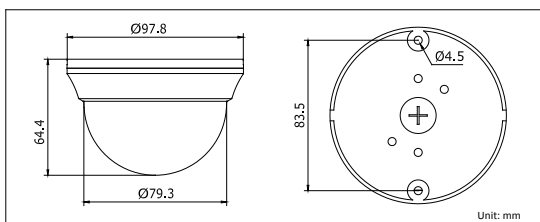

Specifications

DS-2CE5512P(N)	
Camera	
Image sensor	1/4" DIS
Signal system	PAL/NTSC
Effective pixels	640 (H) × 480 (V)
Min. illumination	0.1 Lux @ (F1.2, AGC ON) 0.28 Lux @ (F2.0, AGC ON)
Shutter time	PAL: 1/25 s to 1/15,000 s NTSC: 1/30 s to 1/15,000 s
Lens	2.8 mm @ F2.0 (3.6 mm, 6 mm, optional) Angle of view: 66.2° (2.8 mm)
Lens mount	M12
Angle adjustment	Pan: 0 - 355°, Tilt: 0 - 90°, Rotation: 0 - 355°
Day / night	Electronic
Horizontal resolution	500 TVL
Synchronization	Internal synchronization
Video output	1Vp-p composite output (75 Ω/BNC)
S/N ratio	More than 52 dB
General	
Operating conditions	-40 °C - 60 °C (-40 °F - 140 °F) Humidity 90% or less (non-condensing)
Power supply	12 VDC ± 10%
Power consumption	Max.0.5 W
Dimension	Φ 97.8 x 64.4 mm (Φ 3.85" x 2.54")
Weight	300 g (0.66 lbs)

Available models

DS-2CE5512P, DS-2CE5512N